

# THE MAKING OF FERGUSLIE PARK

## Welcome

The Making of Ferguslie is a plan that sets out a vision for the future of Ferguslie Park over the next five to ten years.

Developed in partnership with the local community, the plan sets out a range of actions to reimagine underused land, improve greenspaces and support community initiatives.

The purpose of this exhibition is to hear your views to help develop the 'Green Line' proposals further and to highlight the progress and works planned for the coming months.

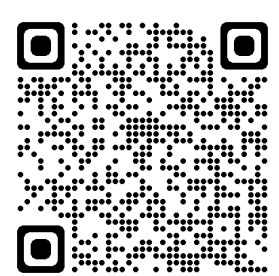

To view The Making Of Ferguslie Plan and initial concepts for the Green Line, scan the QR code or visit:

<https://www.renfrewshire.gov.uk/article/4730/The-Making-of-Ferguslie-Park>

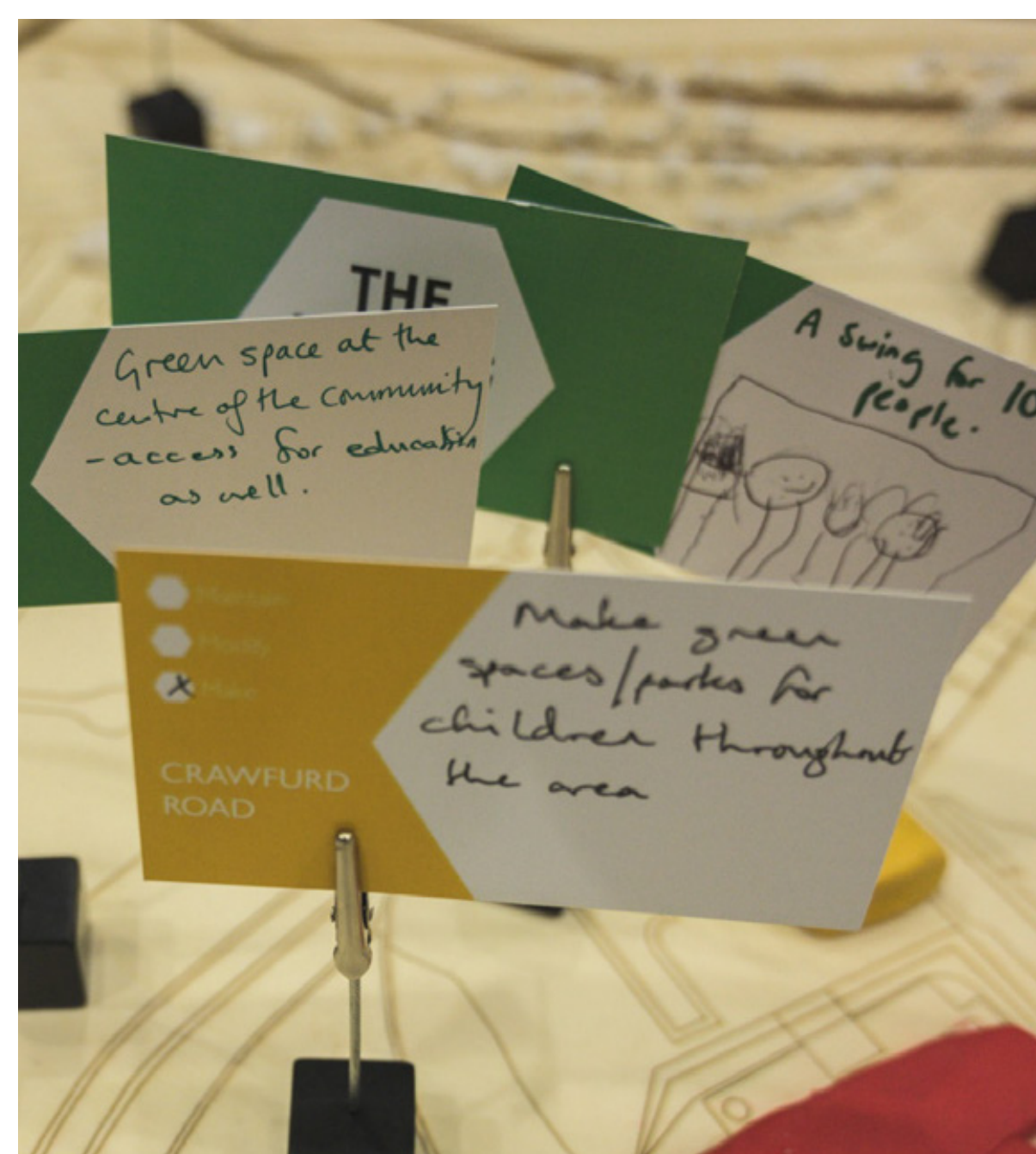



# THE MAKING OF

## THE GREEN LINE

Re-imagining vacant and underused land to enhance Ferguslie Park.

### The Ferguslie 'Green Line'

The Green Line is a new green corridor through Ferguslie Park. The aim is to reuse vacant land, enhance the local environment and create a place where the local community can gather.

A series of plans have been developed for areas within the neighbourhood, informed by the principles and actions within The Making of. These outline proposals for active and informal recreation, natural play and enhancements to the local environment.

Initial phases of the Green Line focus on the Belltrees and Neighbourhood Centre areas, to help bring longer term areas of vacant land into use.

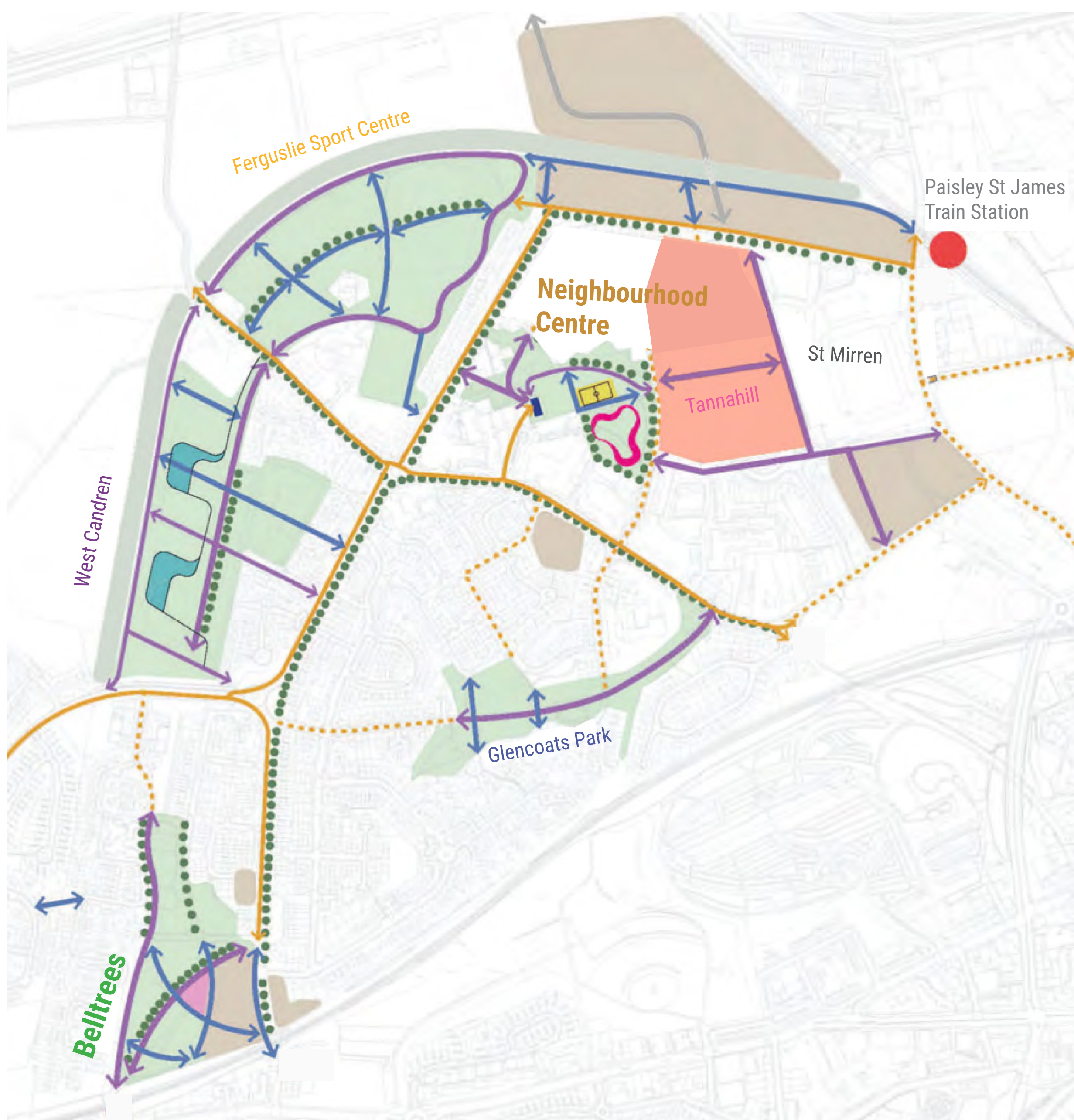

### 'Green Line' Opportunities

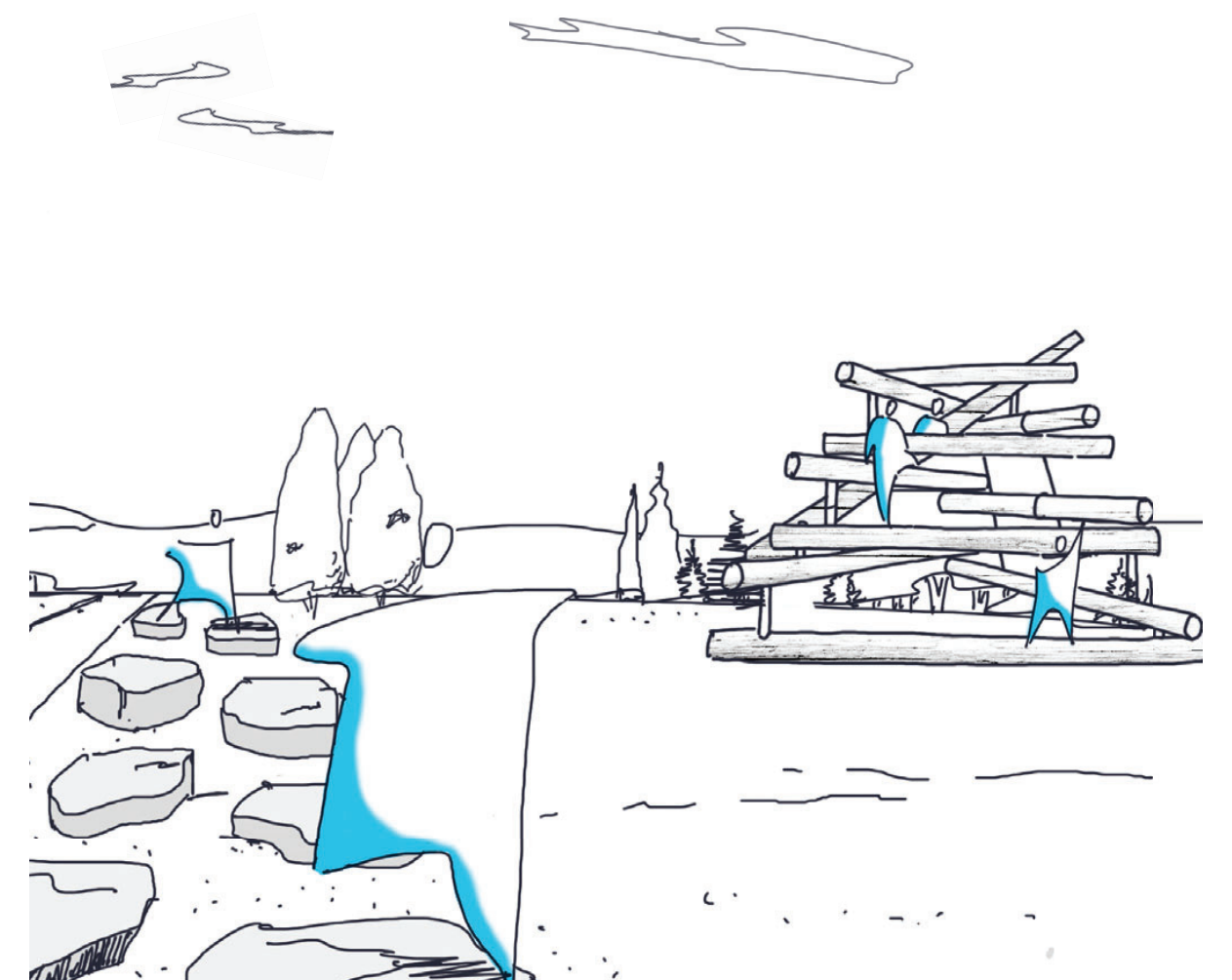

### Play & Learning

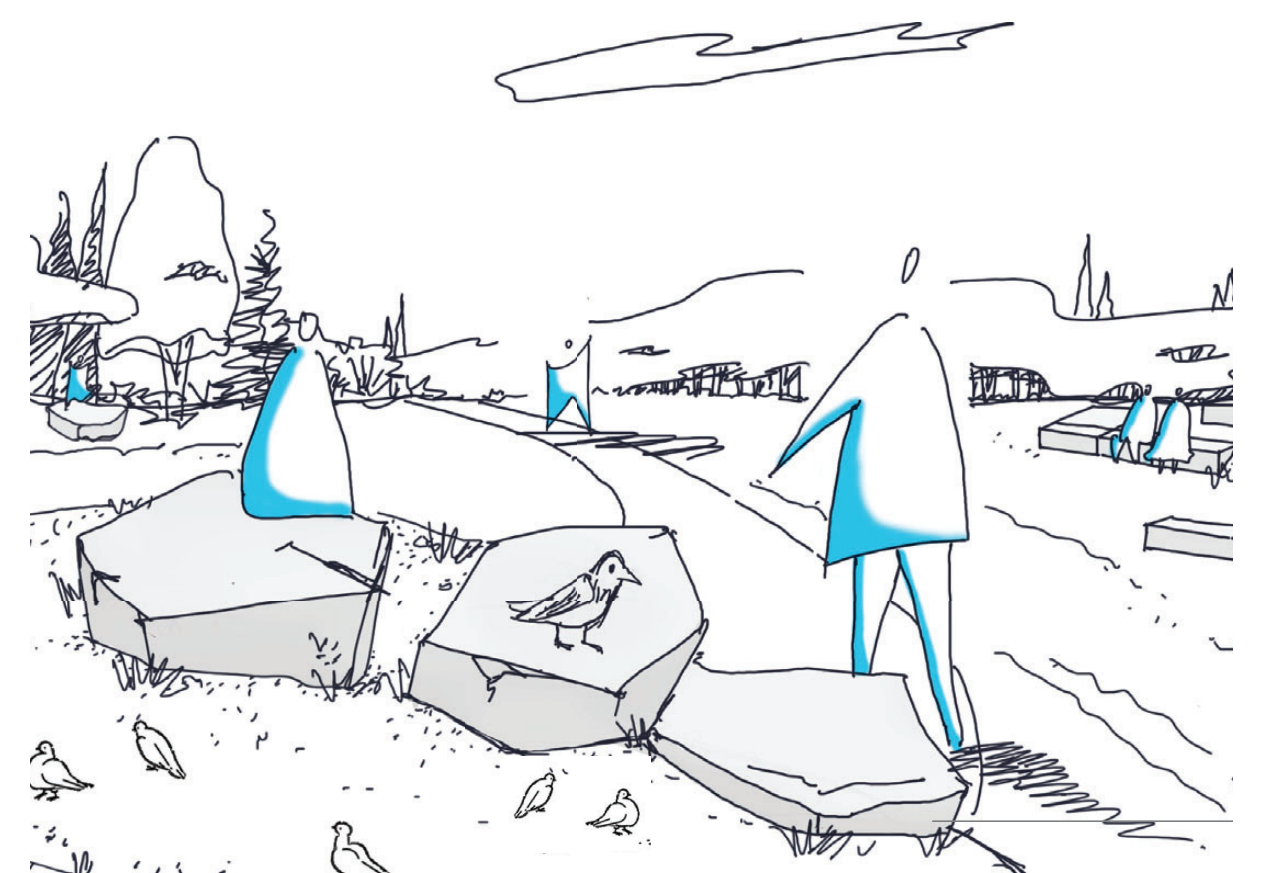

### Nature Trails

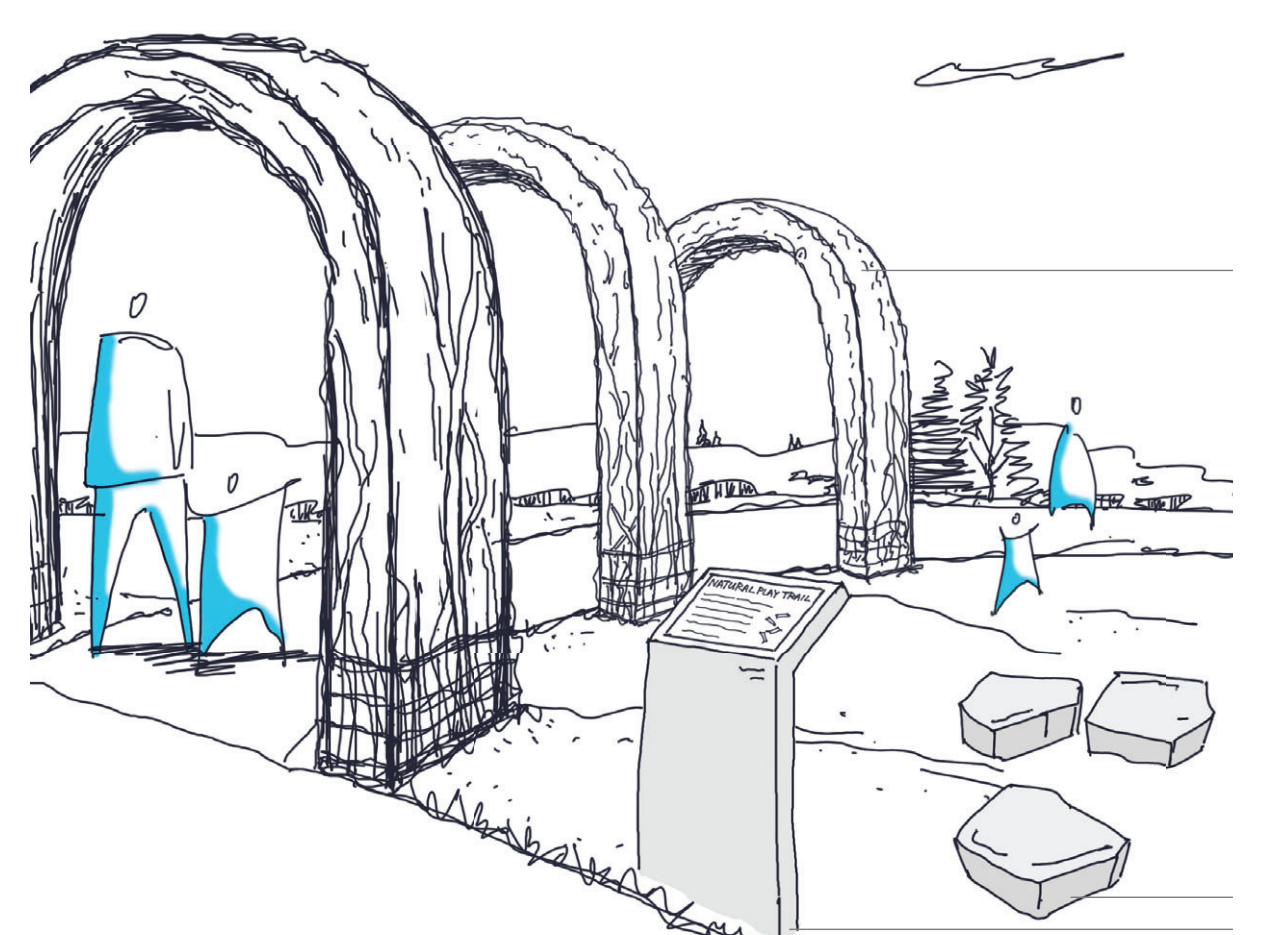

### Improve Gateways



# THE MAKING OF BELLTREES



View 1

## Belltrees

Proposals focus on turning vacant land into an area for recreation. These include new and enhanced paths, creating a nature trail and activity space, informal play opportunities and planting to support greater biodiversity. Enhancements are also proposed at key underpass 'gateways' as shown in the plan below.

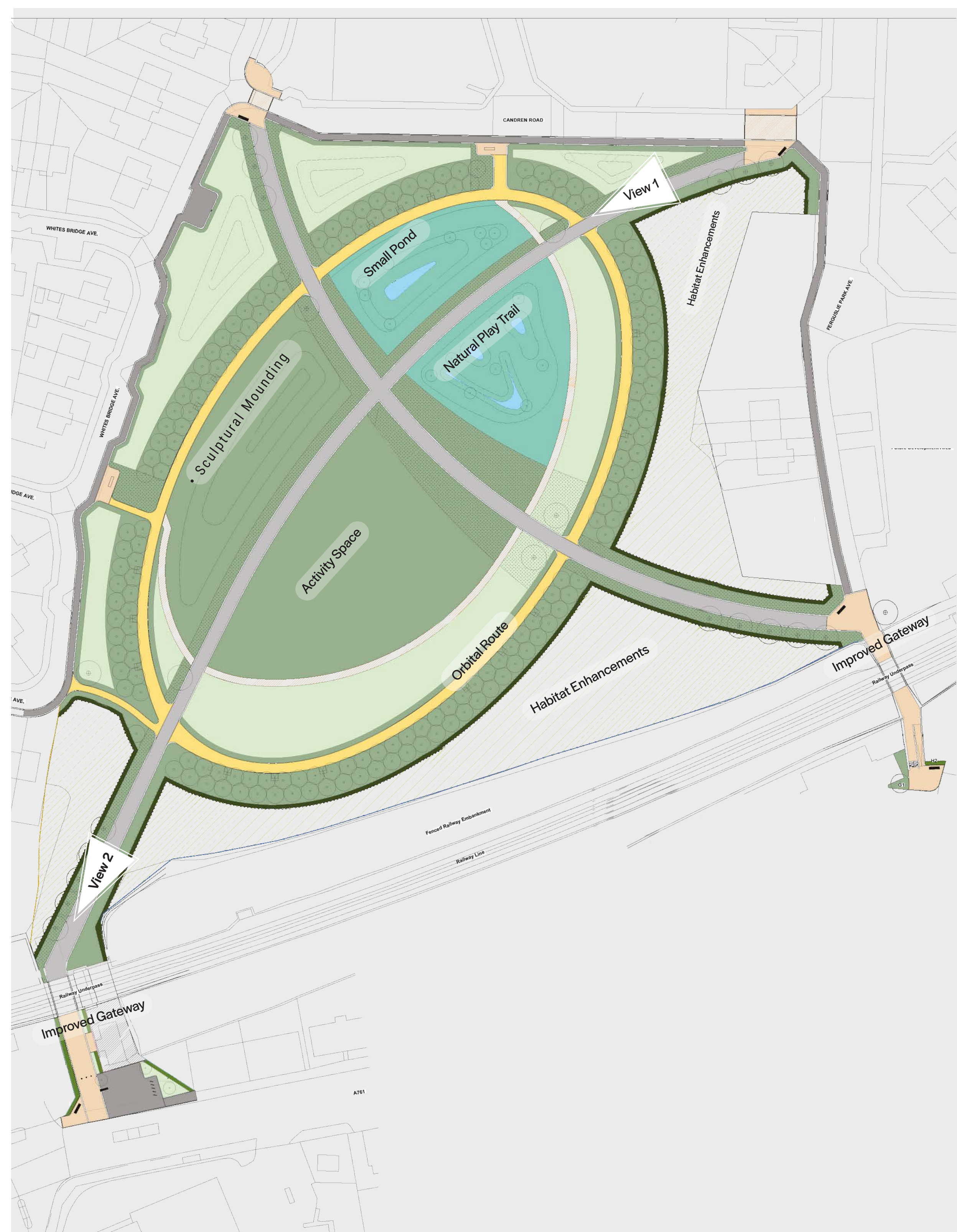

View 2



## Potential Phasing

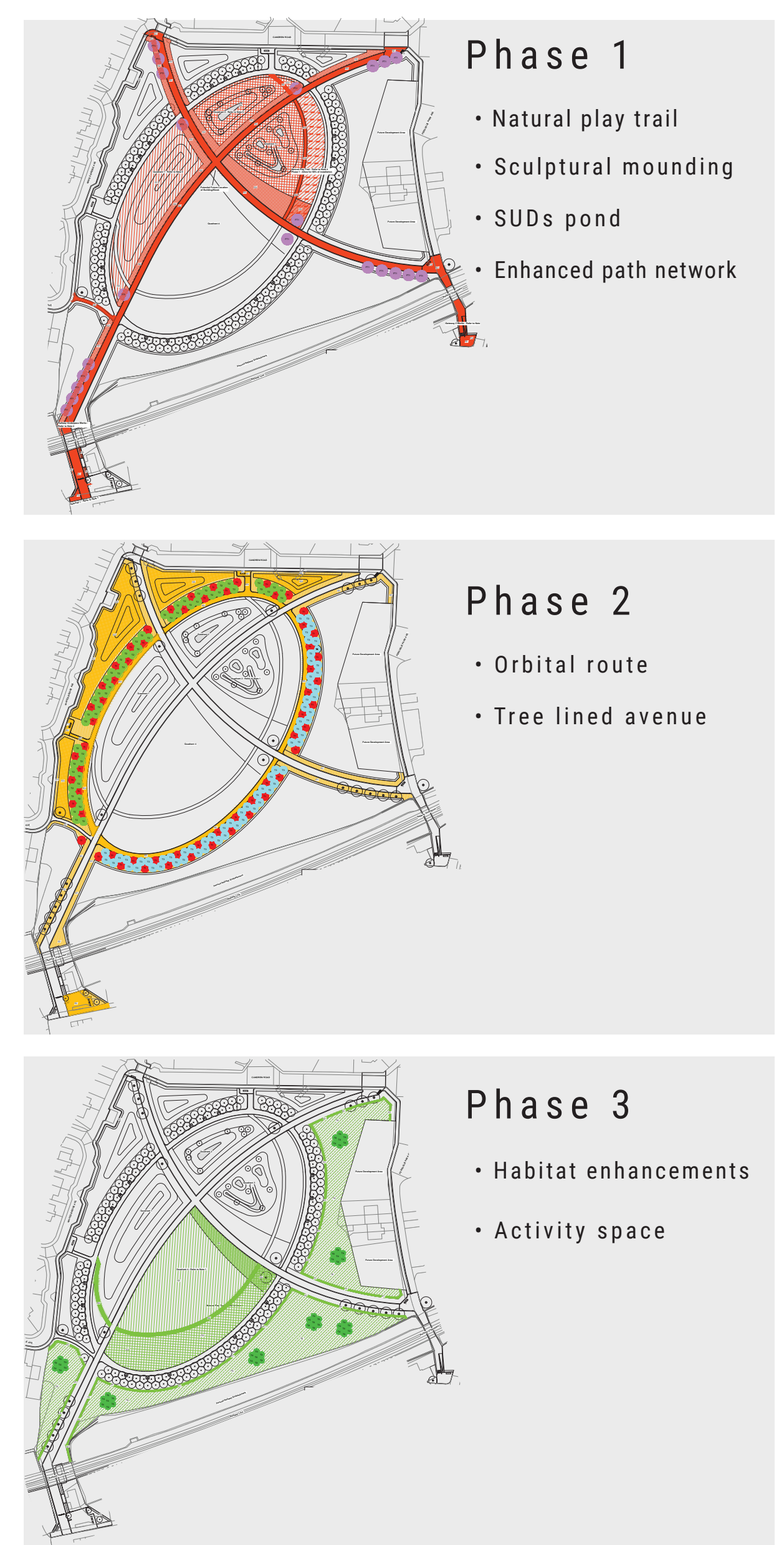



THE  
MAKING  
OF

# NEIGHBOURHOOD CENTRE

View 1

## Neighbourhood Centre

Proposals within this area focus on keeping active and include a new cycle 'pump' track and games area/events space. Plans also include improving paths to existing facilities around the Tannahill Centre, planting and new trees for enhanced biodiversity.



View 2



## Potential Phasing

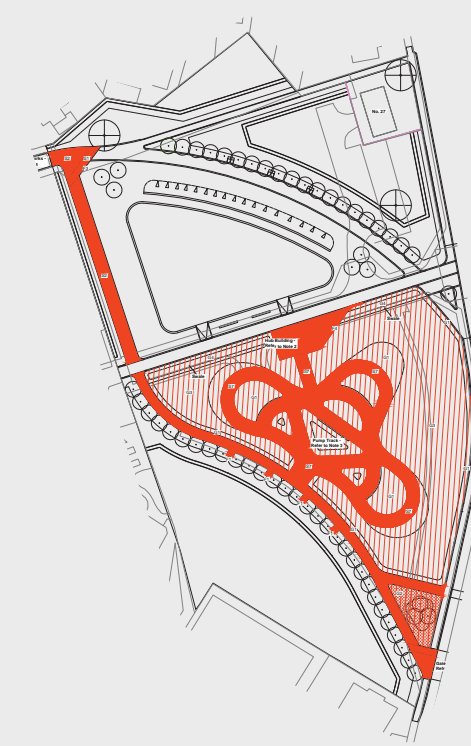

### Phase 1

- Cycle pump track
- Enhance path network

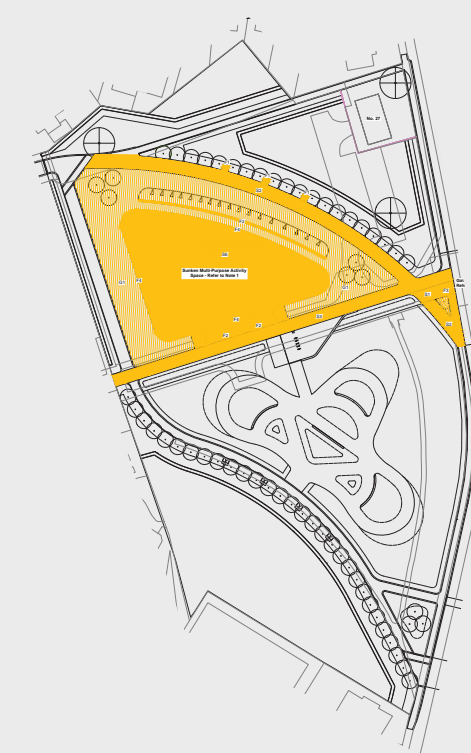

### Phase 2

- Sunken game area/ activity space
- Enhanced path network

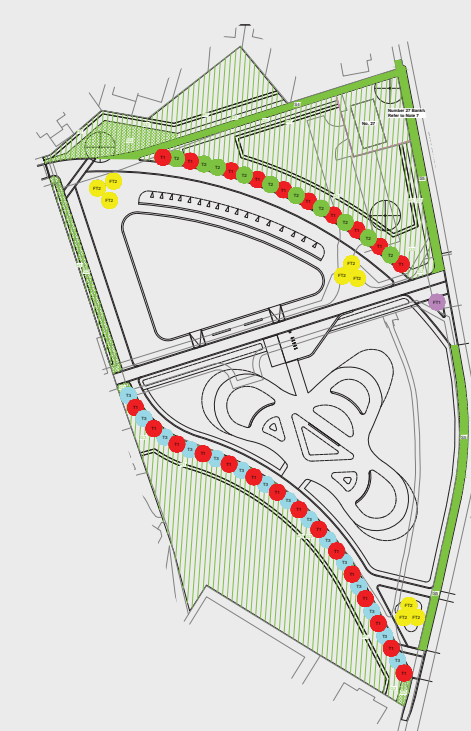

### Phase 3

- Habitat enhancements
- Tree planting



# THE MAKING OF

## PROGRESS AND NEXT STEPS

Good progress has been made on delivering the plan, including New Homes, Sculpture House & Darkwood Growing Space.

### PROGRESS



#### New Homes

101 new Council Homes at the former St Fergus School site.



#### Sculpture House

Craigielea House as an artist studio and social space for the local community.

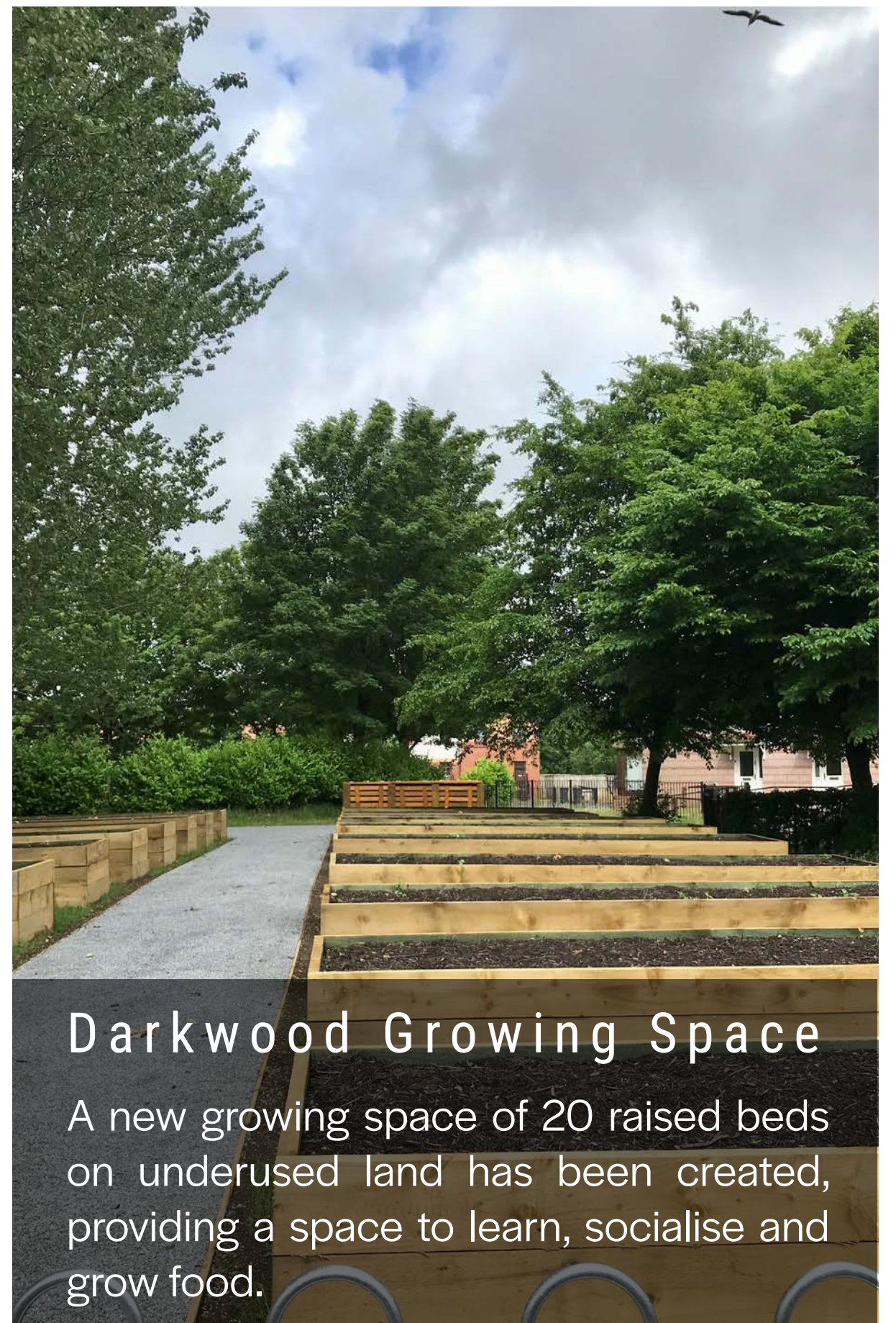

#### Darkwood Growing Space

A new growing space of 20 raised beds on underused land has been created, providing a space to learn, socialise and grow food.

### NEXT STEPS



#### Community Assets

Works to repair St Ninian's Church Hall to ensure the property remains wind and watertight while options are developed by local community groups for lease.

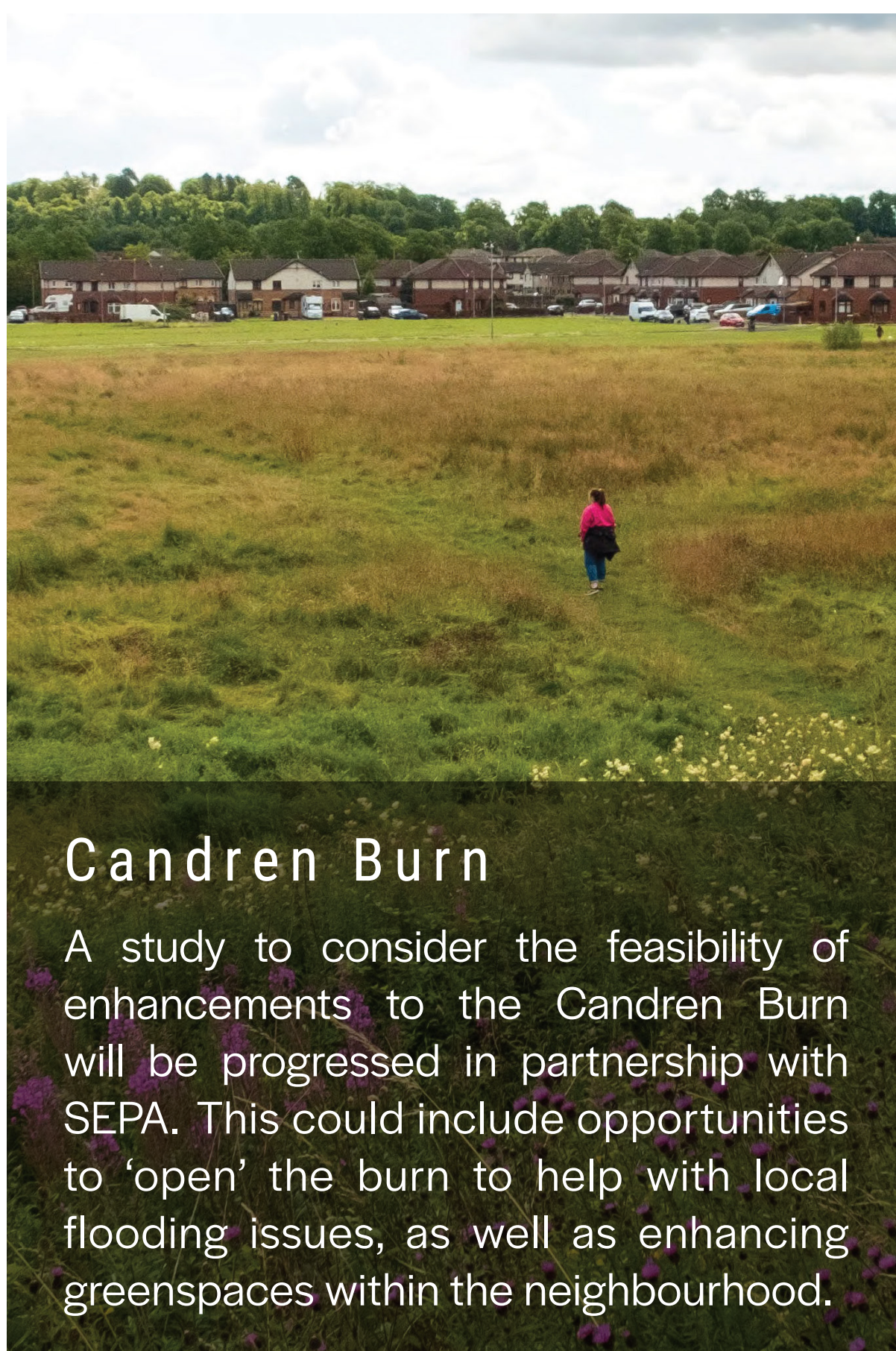

#### Candren Burn

A study to consider the feasibility of enhancements to the Candren Burn will be progressed in partnership with SEPA. This could include opportunities to 'open' the burn to help with local flooding issues, as well as enhancing greenspaces within the neighbourhood.

### CONTACT US

We are keen to hear your views to help develop the 'Green Line' proposals further and continue to progress and deliver The Making of Ferguslie Plan.

Please contact us at:

[themakingof@renfrewshire.gov.uk](mailto:themakingof@renfrewshire.gov.uk)

or call 0300 300 0300

## THANK YOU!